



VSA 250 L 3.0

Art.no: [FAN000050](#)

Product category: Roof fans

Technical data

PACKING	
Weight	7.5 kg
Package unit	Piece
Quantity per pallet	24
Pallet size	1200x800x1900
Quantity per box	1

ELECTRICAL DATA	
Rated power	219 W
Rated current	0.9 A
Phases	1N~ ~
Voltage	230 V
Frequency	50 Hz

FAN	
Motor type	AC
Motor efficiency class	IE3
IP Class	IP44
Impeller material	Plastic
Code	5509312500
On/off switch	None
Constant flow sensor	None
Constant pressure sensor	None
Impeller type	Backwards curved

CASING	
Material	Galvanized steel
Coating	Powder coated
Corrosion resistance external	C3
Color	RAL 9005 (Black)
IP Class	IP54
Operation environment	Outdoors
Operating air temperature	-25 .. 55 °C

Performance

1 Working point

AIRFLOW

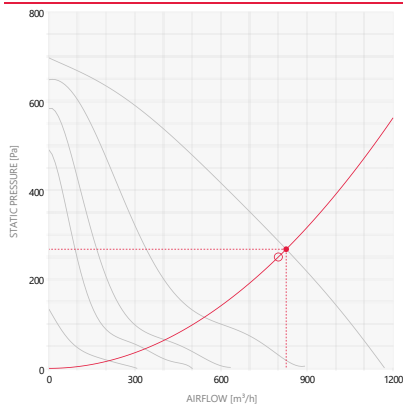

POWER

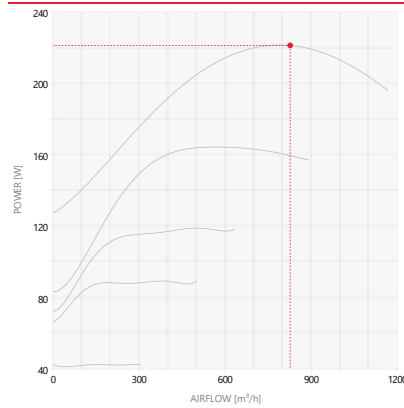

EFFICIENCY

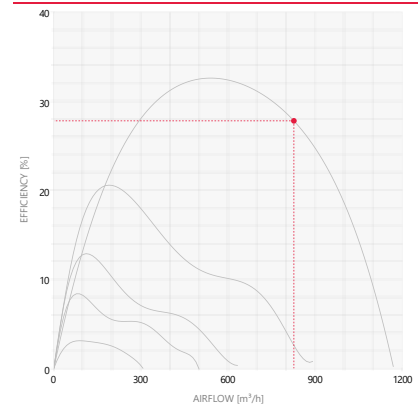

FAN

Air flow	827	m ³ /h
Static pressure	267	Pa
Power	221	W
Current	0.937	A
Efficiency	27.8	%
SFP	0.963	kW/m ³ /s

SOUND POWER

	63 Hz	125 Hz	250 Hz	500 Hz	1 kHz	2 kHz	4 kHz	8 kHz	Total
Inlet [dB]	76	74	74	69	64	57	52	42	71 [dB(A)]
Outlet [dB]	78	75	72	66	63	57	53	44	69 [dB(A)]
Surrounding [dB]	47	47	50	51	53	48	47	46	57 [dB(A)]

Ecodesign

	Cold	Average	Warm	
SEC	-51.8	-24.8	-9.27	kWh/m ² a
Class	A+	C	F	
AEC	141	141	141	kWh/a
AHS	5536	2830	1280	kWh/a
Topology	NRVU / BVU			
Recovery type	-			
Type of drive	Multi-speed			
Maximum airflow	1076		m ³ /h	
Fan power at max airflow	206		W	
Casing sound power level	55.7		dB(A)	
Reference airflow	0.209		m ³ /s	
Reference pressure	51.7		Pa	
SPI	0.21		W/(m ³ /h)	
Control factor	0.65			
Declared maximum external leakage rates	1		%	
ErP Compliance	2018			
Internet address for disassembly instructions	www.salda.lt			

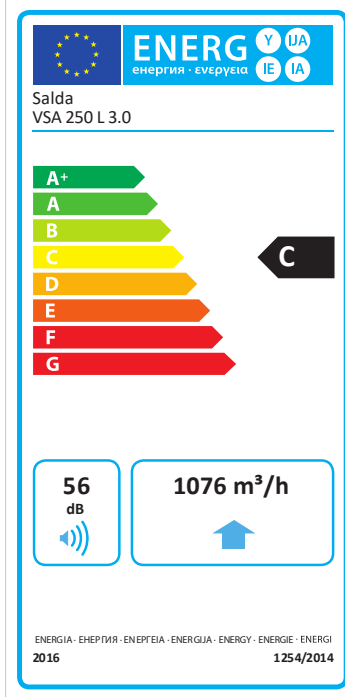

Dimensions

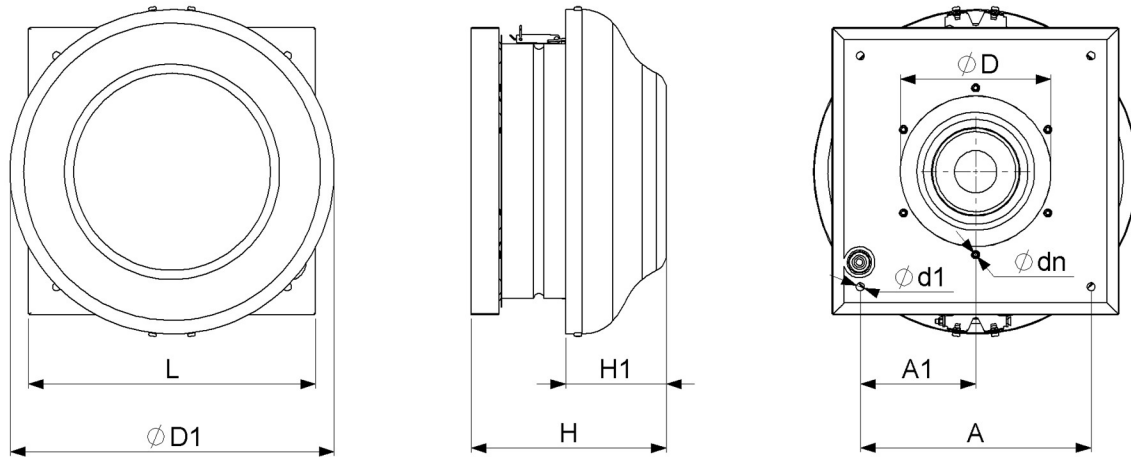

L [mm]	H [mm]	ØD [mm]	dn	H1 [mm]	A [mm]	A1 [mm]	D1 [mm]	d1 [mm]
405	246	200	M5	109	330	165	450	8

Accessories

Electronic AC fan speed controllers



ETY-0-15-AT-SAL [ACC000310](#)

Transformer fan speed controller 1-phase



TGRV 1.5 [ACC000294](#)

ATS



ATS 250 [ACC000075](#)

FSV



FSV 250 [ACC000080](#)

LSV



LSV 250 [ACC000085](#)

KSV



KSV 400-1000 [ACC000100](#)



KSV 400-600 [ACC000101](#)



KSV 400-800 [ACC000102](#)



KSV 400-900 [ACC000103](#)

SSA



SSA 400 [ACC000091](#)

SSA 45



SSA 400 (45) [ACC000092](#)

Documents



Cad drawings

VSA 250 L 3.0 (210,7 KB)



Catalogue

VSA 3.0_EN (716,1 KB)



Certificate

UA certificate fans (1,2 MB)



Declaration of Conformity

FAN_CE_EN 1.1 (106,5 KB)



Manual

VSA 3.0_VSA EKO [DE][SL] v2019.10
(824,8 KB)

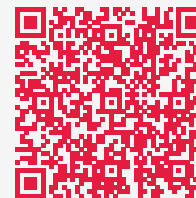

Manual

VSA 3.0_VSA EKO [EN][SL] v2019.10
(834,3 KB)

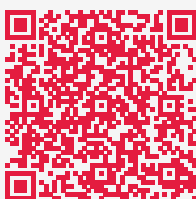

Manual

VSA 3.0_VSA EKO [FR][SL] v2019.10
(837,2 KB)



Manual

VSA 3.0_VSA EKO [IT][SL] v2019.10
(837,9 KB)

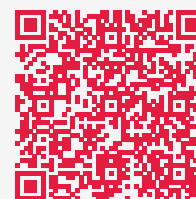

Manual

VSA 3.0_VSA EKO [RU][SL] v2019.10
(750,5 KB)



Sales brochure

Fans_EN 2023 (4,4 MB)